

*Native  
Lumber  
Used  
For All  
Buildings*

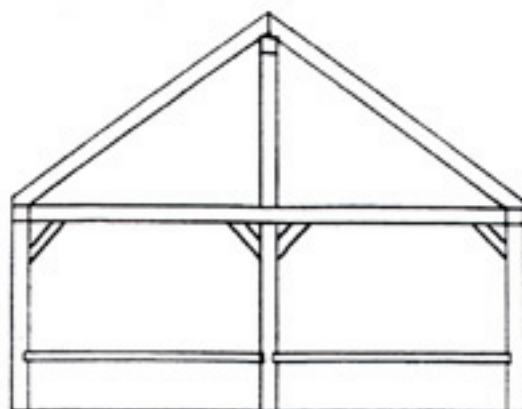

*Lamore Lumber  
will also build to  
your specifications*

### STANDARD GABLE & SALTBOX SHED SIZES & PRICES

SIZE	ROUGH FINISH	SHIPLAP & TONGUE & GROOVE	NOVELTY SIDING
6 X 8	\$1318	\$1565	\$1853
6 X 10	\$1402	\$1670	\$2011
6 X 12	\$1538	\$1822	\$2200
8 X 8	\$1486	\$1764	\$2116
8 X 10	\$1654	\$1964	\$2344
8 X 12	\$1790	\$2132	\$2546
8 X 14	\$2121	\$2536	\$3019
8 X 16	\$2352	\$2704	\$3239
10 X 10	\$1822	\$2168	\$2578
10 X 12	\$2194	\$2605	\$3108
10 X 14	\$2531	\$3023	\$3601
10 X 16	\$2846	\$3408	\$4039
12 X 12	\$2595	\$3092	\$3686
12 X 14	\$2990	\$3574	\$4259
12 X 16	\$3387	\$4039	\$4810
12 X 18	\$3889	\$4655	\$5484
12 X 20	\$4291	\$5131	\$6126

**Kits Available**  
Deduct \$4.00 Sq. Ft. for kits

CT Contractor #572771  
RI Contractor #20380

### POST & BEAM SHED CONSTRUCTION FEATURES SEASONED LUMBER

#### • FRAMING

-POST-	4 X 4 Full Cut
-BEAM-	4 X 6 Full Cut
-KNEE BRACE-	4 X 4 Full Cut
-FLOOR JOISTS-	2 X 6 Full Cut
-RAFTERS-	3 X 4 Full Cut

#### • EXTERIOR

-SIDING-	1 X 12 Full Cut
-FLOOR & ROOF-	1" Full Cut
-FOOTINGS-	8 X 8 X 16 Cement Blocks
-BATTENS-	1 X 2-1/2 Full Cut
All Windows Include Flower Box and Shutters	

#### OPTIONAL FEATURES

Extra Doors.....	\$75.00
Extra Windows 4 pane (21" X 27") ..	\$75.00
Extra Windows 6 pane (18" X 36") ..	\$95.00
Extra Windows 8 pane (21" X 46") ..	\$140.00
Gable Vents Available.....	\$50.00
Double Doors.....	\$55.00
Cupolas Available.....	
Installation of Cupola .....	\$175.00 each

Pressure Treated Floor Joists .... \$1.50 per sq. ft.  
Shiplap Floor .... \$1.50 per sq. ft.  
12/12 Pitch - Add 25%

#### Charge for Carrying Lumber

Generator Charge is \$75.00 per day  
Gambrel Style Roof - Add 35%  
Screen Buildings - Add 25%

Porch on shed \$23.00 per sq. ft. on Gable end,  
\$26.00 per sq. ft. on Eave side.

Porch for Tongue and Groove or Shiplap  
\$26.00 per sq. ft. on Gable end,  
\$29.00 per sq. ft. on Eave side.

MA Home Improvement # 120052